

# STANLEY

®

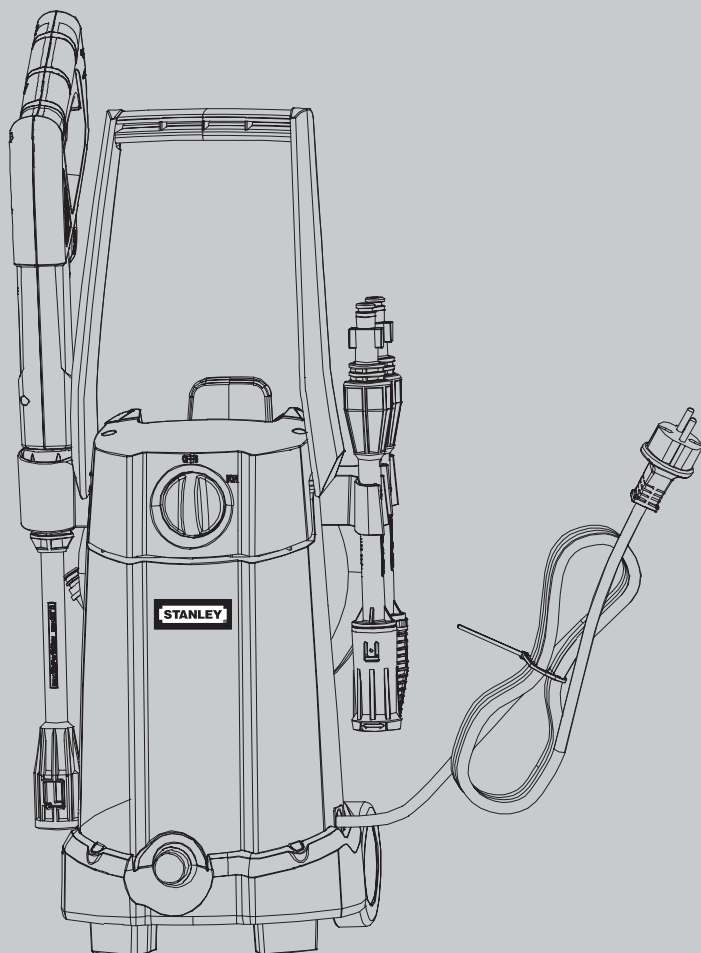

**STPW1400**

English  
繁体中文

04  
09



*Read this manual through carefully before installing/using the cleaner, paying special attention to the SAFETY INSTRUCTIONS*



安裝 / 使用清潔機之前，請仔細閱讀本手冊，特別注意「安全指示」

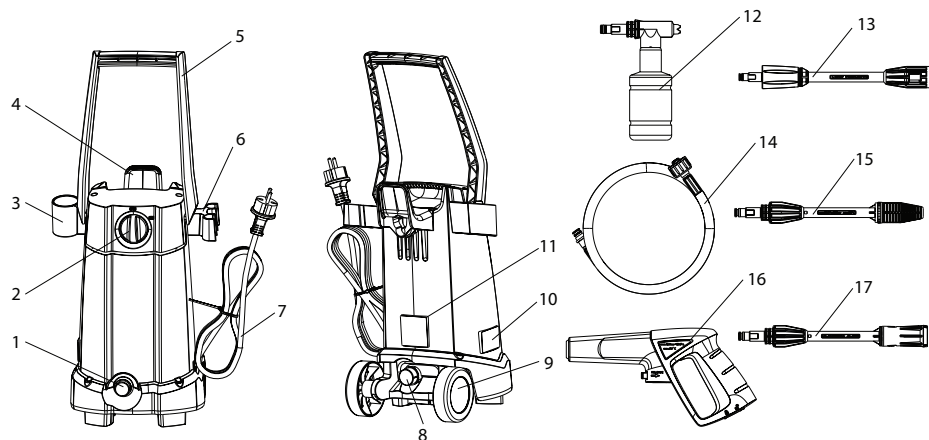

Fig.1

Fig.2

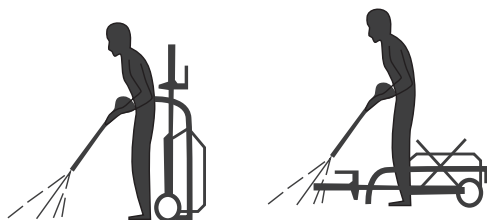

Fig.3

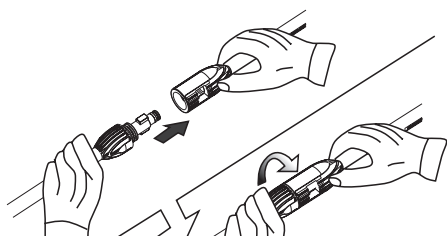

Fig.4

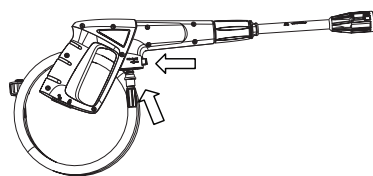

Fig.5

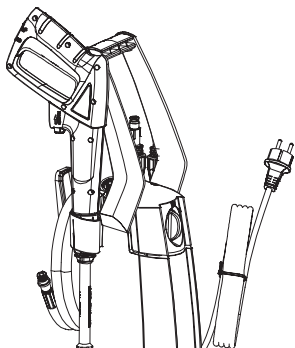

Fig.6

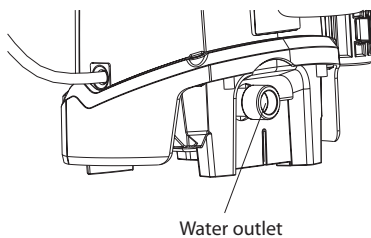

Fig.7

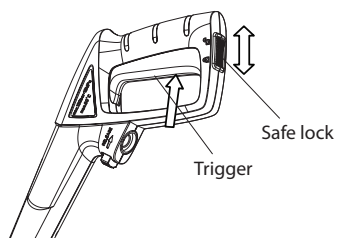

Fig.8

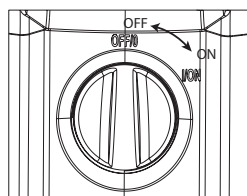

Fig.9

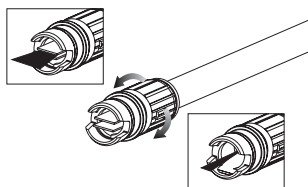

Fig.10

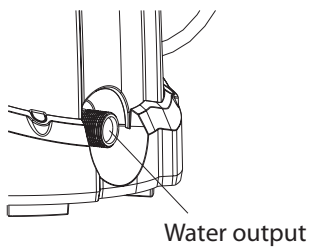

Fig.11

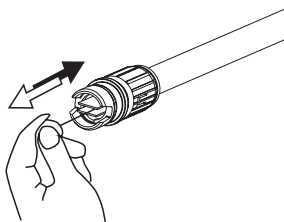

Fig.12

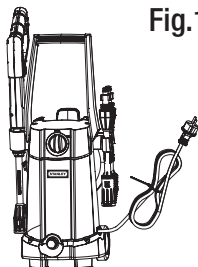

Fig.13



# STPW1400 PRESSURE WASHER

## Technical data

Model. No	
Rated voltage	110V
Rated input power	1400W
Protection class	II
Degree of protection	IPX5
Rated pressure	7MPa
Max. pressure	10MPa
Rated flow	5.5 l/min
Max. flow	6.5l/min
Rated temperature	0–40°C
Max. inlet pressure	0.7MPa
Weight	5.32 Kg

## SYMBOLS USED TO MARK INSTRUCTIONS

Some of the following symbols may be used on this product. Please study them and learn their meaning for safe operation.

SYMBOL	NAME	EXPLANATION
	<b>Read instruction</b>	Before starting up your high pressure washer for the first time, this instruction manual must be read through carefully. Save the instructions for later use.
	<b>Safety Alert</b>	Safety instructions marked with this symbol must be observed to prevent danger to persons.
	<b>Safety mark</b>	This symbol is used to mark safety instructions that must be observed to prevent damage to the machine and its performance
	<b>Indication mark</b>	This symbol indicates tips and instructions to simplify work and to ensure a safe operation.
	<b>Waste products disposal</b>	Waste electrical products should not be disposed of with household waste.
	<b>Eye Protection</b>	Always wear safety goggles or safety glasses with side shields or a full face shield when operating this product.
	<b>Class II Construction</b>	Double-insulated construction.

	<b>keep Bystanders Away</b>	To reduce the risk of injury, user must keep all bystanders at least 15m away.
	<b>Electric Shock Precaution</b>	Remove plug from the mains immediately if cable is damaged or cut.
	<b>Electrical shock hazard</b>	Electrical shock hazard
		Machine not suitable for connection to the potable water mains

The following signal words and meanings are intended to explain the levels of risk

## ASSOCIATED WITH THIS PRODUCT

Symptom	Signal	Meaning
	<b>Danger</b>	Indicates an imminently hazardous situation which, if not avoided, will result in death.
	<b>Warning</b>	Indicates a potentially hazardous situation which, if not avoided, could result in death or serious injury.
	<b>Caution</b>	Indicates a potentially hazardous situation which, if not avoided, may result in minor or moderate injury.
	<b>Caution</b>	(Without Safety Alert Symbol) Indicates a situation that may result in property damage.

## IMPORTANT SAFETY INSTRUCTIONS

### **WARNING!**

This appliance is not intended for use by children or other persons without assistance or supervision if their physical, sensory or mental capabilities prevent them from using it safely. Children should be supervised to ensure that they do not play with the appliance.

Before starting up your machine please check it carefully for any defects. If you find any, do not start up your machine and contact your distributor.

### **ESPECIALLY CHECK**

The insulation of the power cord should be faultless and without any cracks. If the power cord is damaged, an authorized distributor should replace it.

# **WARNING!**

**Warning: Do not use this appliance without reading this instruction sheets.**

- The electric supply connection shall be made by a qualified electrician and comply with IEC60364-1.
- The Electric supply to this appliance should include either a residual current device that will interrupt the supply if the leakage current to earth exceeds 30 mA for 30 ms or a device that will interrupt the earth circuit.
- **WARNING:** This appliance has been designed for use with the cleaning agent supplied or recommended by the manufacturer. The use of other cleaning agents or chemicals may adversely affect the safety of the appliance.
- **WARNING:** Do not use the appliance within range of persons unless they wear protective clothing.
- **WARNING:** High pressure jets can be dangerous if subject to misuse. The jet must not be directed at persons, live electrical equipment or the appliance itself.
- Do not direct the jet against yourself or others in order to clean clothes or foot-wear.
- Risk of explosion
- Do not spray flammable liquids.
- Disconnect from the electrical power supply before carrying out user maintenance .
- High pressure cleaners shall not be used by children or untrained personnel.
- To ensure appliance safety, use only original spare parts from the manufacturer or approved by the manufacturer.
- **WARNING:** Water that has flown through backflow preventers is considered to be non-potable.
- **WARNING:** The machine shall be disconnected from its power source during cleaning or maintenance and when replacing parts for mains operated machines by removing the plug from the socket-outlet;
- **WARNING:** High pressure hoses, fittings and couplings are important for safety of the appliance. Use only hoses, fittings and couplings recommended by the manufacturer.
- Do not use the appliance if a supply cord or important parts of the appliance are damaged, e.g. safety devices, high pressure hoses, trigger gun.
- **WARNING:** If an extension cord is used, the plug and socket must be of watertight

construction.

- **WARNING:** Inadequate extension cords can be dangerous.
- This high pressure washer must not be used at temperatures below 0° C.

# **WARNING!**

- Cord on drums should always be completely unwinded to prevent the cord from overheating.
- If an extension cord is used, the plug and socket must be of watertight construction.
- Inadequate extension cords can be dangerous.
- comply with the below-mentioned requirements for length and cord dimensions.

1.0 mm<sup>2</sup> max. 12.5 m

1.5 mm<sup>2</sup> max. 20 m

2.5mm<sup>2</sup> max. 30 m

Power cord connections should be kept dry and off the ground.

If the power cord is damaged, it must be replaced by the manufacturer or his service agent or similarly qualified person in order to avoid a hazard.

All keep the machine on a stable and flat surface during operation, handling, transportation and storage. Sudden overturn of machine will cause injury to body.

In the event of accident or breakdown, switch off the machine immediately. (e.g. contact with detergent: rinse with an abundance of clean water)

# **ATTENTION!**

Through poor conditions of the electrical MAINS, shortly voltage drops can appear when starting the EQUIPMENT. This can influence other equipment (eg. Blinking of a lamp). If the MAINS-IMPEDANCE  $Z_{max} < 0.335 \text{ OHM}$ , such disturbances are not expected. (In case of need, you may contact you local supply authority for further information.)

# **WARNING! ELECTRICAL SHOCK HAZARD**



Improper connection of the equipment-grounding conductor can result in a risk of electrical shock. Check with a qualified electrician or service person if you are unsure if an outlet is properly grounded. DO NOT modify the plug provided with the appliance to fit an outlet, have a proper outlet installed by a qualified electrician.

# **MAINS POWER CONNECTION**



The following should be observed when connecting the high pressure washer to the electric installation:

- The electric installation shall be made by a

- certified electrician and comply with IEC-364.
- It is recommended that the electric supply to this appliance should include either a residual current device that will interrupt the supply if the leakage current to earth exceeds 30 mA for 30 ms.

### **IMPORTANT!**

#### **Only use water without any impurities.**

If there is a risk of running sands in the inlet water (i.e. from your own well), an additional filter should be mounted.

### **SAFETY DEVICES**

The unloader valve can reduce pressure if it exceeds pre-set values. The spray gun features a locking device. When the pawl is activated, the spray gun cannot be operated.

#### **Thermal sensor:**

A thermal sensor protects the motor against overloading. The machine will restart after a few minutes when the thermal sensor has cooled.

### **NAME OF PARTS: (FIG. 1)**

1. Water outlet
2. On/off switch
3. Gun holder
4. High pressure hose holder
5. Handle
6. Lance holder
7. Power cord
8. Water inlet
9. Wheel
10. Warning label
11. Rating label
12. Detergent bottle
13. Middle lance
14. High pressure hose
15. Turbo lance
16. Gun
17. Lance

### **PRODUCT DESCRIPTION**

#### **PURPOSE**

- The high pressure cleaner is designed to clean vehicles, machines, buildings, facades, etc. in the private sector.

#### **AREAS OF APPLICATION**

- Never use the machine in potentially explosive areas under any circumstances!
- The operating temperature must be between 0 and +40°C.
- The machine consists of an assembly with a pump, which is encased in a shock absorbing

housing. For an optimal working position the machine comes with a lance and a non-slip handle grip, whose shape and configuration comply with the applicable regulations.

- Do not cover or modify the lance or the spray nozzles in any way.
- The high pressure cleaner is designed to be used with cold or lukewarm (max. 60°C); higher temperatures can damage the pump.
- Do not use water that is dirty, gritty or contains any chemical products, as these could impair operation and shorten the life of the machine.
- Accessories can be used to carry out work with foam cleaners, sand spraying.

### **ASSEMBLY**

- Position the washer as NEAR as possible to the water supply.
- The washer must be used standing on a secure, stable, positioned as shown. FIG.2.
- Fit the lance into the gun and rotating it until the two parts are completely locked FIG. 3
- Connect the gun to the high pressure hose FIG.4
- Connect the high pressure hose to the water outlet on the washer FIG.5.
- Connect the water supply hose to female coupler FIG.6, then connect to the water inlet of the washer. The supply hose must have an internal diameter of at least 13mm (1/2 in.) and must be reinforced. The water supply must be at least equal to the washer delivery capacity.
- **NOTE: The machine not suitable for connection to the potable water main (FIG. 13).**

 **WARNING!** The intake water temperature must not exceed 40°C. The water supply must not exceed 0.7 MPa.

 **CAUTION!** The washer must only be used with clean water; use of unfiltered water of corrosive chemicals will damage the washer.

- Push the motor switch to "OFF" position FIG. 8.
- Check that the electrical supply voltage and frequency (Volt/Hz) correspond to those specified on the washer rating plate. If the power supply is correct, you may now plug in the washer.

### **OPERATION**

- Turn on the water supply tap fully.
- Release the safety lock FIG.7, then press the

trigger for a few seconds to allow air to escape and to discharge residual pressure in the hose.

- Keeping the trigger pressed, push the switch to start the motor FIG.8.
- When re-starting the motor, always keep the trigger pressed.

**NOTE:**

**THE MOTOR ONLY RUNS WHEN THE TRIGGER IS OPERATED.**

**CORRECT USE OF STANDARD ACCESSORIES**

- The washer is equipped with the adjustable nozzle.
- Jet adjustment from pencil to fan FIG.9

**⚠ WARNING: DO NOT ADJUST THE NOZZLE WHILE THE TRIGGER IS SQUEEZED.**

**RECOMMENDED CLEANING PROCEDURE**

- Dissolve dirt by applying detergent with the fan jet to the dry surface. On vertical surfaces, work from the bottom upwards. Leave the detergent to act for 1 to 2 minutes, but do not allow to dry out. Apply the high from the surface, working from the bottom upwards.
- Avoid allowing the rinsing water to run on to unwanted surfaces.

**STORAGE (FIG.10 – FIG. 12)**

- Switch off the washer.
- Turn off the water supply tap.
- After use, the detergent residuals should be removed from the tank.
- Discharge residual pressure by pressing the trigger until no more water comes out of the lance nozzle.
- Engage the gun safety lock.
- Remove the plug from the socket.
- Operate the washer with non-corrosive/ non-toxic antifreeze before storing for the winter.

**⚠ WARNING: BEFORE REUSING, COMPLETELY FLUSH THE UNIT OUT WITH PLAIN WATER. ANTI-FREEZE CAN DAMAGE PAINTWORK SO YOU MUST ENSURE THERE IS NO ANTI-FREEZE LEFT IN THE SYSTEM BEFORE USING IT AGAIN.**

**MAINTENANCE**

**⚠ CAUTION! Before working on the washer, disconnect the lug from the power supply socket**

- To ensure good performance, check and clean the suction and detergent filters after every 50 hours of operation FIG. 11.
- Clean the nozzle with the tool provided. Remove

the lance from the gun; remove any dirt from the nozzle hole (FIG. 12) and rinse.

**TROUBLE-SHOOTING**

Disconnect from the electrical power supply before carrying out user maintenance or checking its correct functioning.

To avoid unnecessary disappointments, you should check the following before contacting the service organization:

Symptom	Cause	Recommended action
Machine refuses to start	Machine not plugged in Defective socket Fuse has blown Defective extension cord	Plug in machine Try another socket. Replace fuse. Switch off other machines. Try without the extension cord.
Fluctuating pressure	Pump sucking air Valves dirty, worn out or stuck Pump seals worn out	Check that hoses and connections are airtight. Clean and replace or refer to local distributor Clean and replace or refer to local distributor
Machine stops	Fuse has blown Incorrect mains voltage Thermal sensor activated Nozzle partially blocked	Replace fuse. Switch off other machines. Check that the mains voltage corresponds to specification on the model tag. Leave the washer for 5 minutes to cool down. Clean the nozzle
Fuse blows	Fuse too small	Change to an installation higher than the amp. consumption of the machine. You may try without the extension cord.
Machine pulsating	Air in inlet hose Inadequate supply of mains water Nozzle partially blocked Water filter blocked Hose kinked	Allow machine to run with open trigger until regular working pressure resumes. Check that the water supply corresponds to specifications required NB! Avoid using long, thin hoses (min. 1/2" ) Clean the nozzle Clean the filter Straighten out hose.
Machine often starts and stops by itself	Pump/spray gun is leaking Centre.	Contact your nearest Service
Machine starts but no water comes out	Pump/hoses or accessory frozen No water supply Water filter blocked Nozzle blocked	Wait for pump/hoses or accessory to thaw. Connect inlet water. Clean the filter Clean the nozzle

In case problems other than the above occur, please contact your local distributor.



## CIRCUIT DIAGRAM

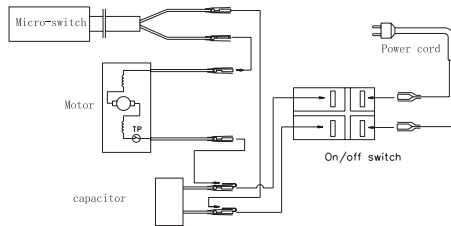

## DISPOSAL

### Recycling the washer



Do not dispose of electrical appliances as unsorted municipal waste, use separate collection facilities.

Contact your local government for information regarding the collection systems available.

If electrical appliances are disposed of in landfills or dumps, hazardous substances can leak into the groundwater and get into the food chain, damaging your health and well-being.

When replacing old appliances with new ones, the retailer is legally obligated to take back your old appliance for disposals at least free of charge.

## SAVE THESE INSTRUCTIONS

## STPW1400

## 高壓清洗機

## 技術資料

## 型號

額定電壓	110V
額定輸入功率	1400W
保護級別	II
保護等級	IPX5
額定壓力	7MPa
最大壓力	10MPa
額定流量	5.5 l/min
最大流量	6.5l/min
額定溫度	0-40℃
最大入口壓力	0.7MPa
重量	5.32Kg

## 用於標記指示的符號

本產品上可能使用了以下一些符號。請學習這些符號並瞭解其對於安全作業的含義。

符號	名稱	說明
	閱讀指示	第一次啟動高壓清洗機之前，必須仔細閱讀本指示手冊。妥善保管指示以備將來使用。
	安全警告	必須遵守標有此符號的安全指示以防止對人構成危害。
	安全標記	此符號用於標記為防止機器損壞及其效能而必須遵守的安全指示
	指示標記	此符號指出了用於簡化工作及確保安全作業的提示與指示。
	廢棄產品處置	廢棄電氣產品不得與家庭廢物一起處置。
	護目裝備	操作本產品時，務必佩戴配有側護罩或全面式護罩的護目鏡。
	II級結構	雙重絕緣結構。

	讓圍觀者遠離	若要降低傷害風險，使用者必須讓所有圍觀者遠離至少 15m。
	觸點預防措施	如果電纜損毀或被切斷，請從主電源中拔出插頭。
	觸電危險	觸電危險
		機器不適合連接至飲用水總管

以下信號詞及含義用於說明風險級別

## 與本產品相關

症狀	信號	含義
	危險	表示緊急危險情況，若未能避免，將導致死亡。
	警告	表示潛在危險情況，若未能避免，可能導致死亡或嚴重傷害。
	小心	表示潛在危險情況，若未能避免，可能導致輕微或中度傷害。
	小心	（無安全警告符號）表示可能會導致財產損失的情況。

## 重要安全指示

## ⚠ 警告！

體力、感覺或智力不足的兒童或其他人員必須在協助或監督下使用本器具，以確保安全使用。必須監督小孩，確保他們沒有耍玩器具。

啟動機器之前，請仔細檢查機器是否存在任何缺陷。如發現缺陷，請不要啟動機器，並與您的經銷商聯絡。

## 重點檢查

電源線的絕緣應完好且無任何裂縫。如果電源線損毀，則授權的經銷商應將其更換。

**⚠ 警告！****警告：如未閱讀本指示表，請勿使用本器具。**

- 供電連接應由合格的電工完成且符合IEC60364-1標準。
- 本器具的供電設備應包括將在接地漏電流超過30毫安的時間持續30毫秒時中斷電源的漏電保護器或將中斷接地電路的裝置。
- **警告：**本器具可與隨附的清潔劑或製造廠商推薦的清潔劑配合使用。使用其他清潔劑或化學品可能會對器具的安全產生不利影響。
- **警告：**請勿在人的活動範圍內使用本器具，除非他們已穿防護服。
- **警告：**如果誤用，高壓噴射可能會非常危險。不得對著人、帶電的電氣設備或器具本身噴射。
- 請勿對著自己或其他人噴射來清潔衣物或鞋襪。
- 爆炸風險
- 請勿噴射易燃液體。
- 進行使用者維護之前，請斷開與電源的連接。
- 兒童或未經培訓的人員不得使用高壓清潔機。
- 為了確保器具安全，請僅使用製造廠商生產或製造廠商認可的原廠備件。
- **警告：**流經迴流防止器的水被視為非飲用水。
- **警告：**在清潔或維護期間或在更換電源驅動機器的部件時，應從插座中拔出插頭，斷開機器與其電源的連接。
- **警告：**高壓軟管、接頭和聯結器對於器具的安全至關重要。僅使用製造廠商推薦的軟管、接頭和聯結器。
- 如果器具的電源線或重要部件損毀（如，安全裝置、高壓軟管、觸發槍），請勿使用器具。
- **警告：**如果使用延長電線，則插頭與插座必須為不透水結構。
- **警告：**延長電線不夠可能會非常危險。
- 此高壓清洗機不得在低於0°C的溫度下使用。

**⚠ 警告！**

- 圓筒上的電線應始終完全展開以免電線過熱。
- 如果使用延長電線，則插頭與插座必須為不透水結構。
- 延長電線不夠可能會非常危險。
- 長度與電線尺寸應符合下述要求。  
1.0 mm<sup>2</sup> 最長12.5 m  
1.5 mm<sup>2</sup> 最長20 m  
2.5mm<sup>2</sup> 最長30m

電源線連接應保持乾燥且脫離地面。

如果電源線損毀，則必須讓製造廠商、維修代理或類似合格人員更換以避免發生危險。

在作業、處理、運輸與儲存期間，務必將機器置於平穩表面。突然推倒機器將會導致人身傷害。

如果發生意外或故障，請立即關閉機器。（例如，接觸到洗滌劑：使用大量乾淨的水沖洗）

**⚠ 注意！**

如果主電源的狀況不佳，則在啟動設備時可能會出現短時間的電壓下降。這可能會影響其他設備（如，燈具閃爍）。如果主電源阻抗 $Z_{max} < 0.335$  歐姆，則預計不會出現此類干擾。（如有需要，您可以聯絡當地的供電機構以取得進一步資訊。）

**警告！觸電危險**

設備接地導電體連接不當可能會導致觸電風險。如果您不確定插座是否正確接地，請與合格的電工或維修人員進行確認。不要為了配合插座而改裝器具隨附的插頭，讓合格的電工安裝合適的插座。

**主電源連接**

在以下情況下應遵守下列各項：

將高壓清洗機連接至電氣裝置：

- 電氣安裝應由經認證的電工完成且符合IEC-364標準。

- 建議本器具的供電設備應包括將在接地漏電流超過30毫安的時間持續30毫秒時中斷電源之漏電保護器。

### 重要資訊！

#### 僅使用不含任何雜質的水。

如果入口的水（如，來自自己的井道）中可能存在流沙，則應安裝其他過濾器。

### 安全裝置

如果壓力超過預設值，則調壓閥可降低壓力。噴槍具有鎖定裝置。棘爪啟動時，噴槍無法使用。

#### 熱感應器：

熱感應器可防止電動機過載。機器將在熱感應器冷卻幾分鐘後重新啟動。

### 部件的名稱：（圖1）

1. 出水口
2. 開關
3. 槍托
4. 高壓管掛扣
5. 手柄
6. 槍桿托
7. 電源線
8. 進水口
9. 輪子
10. 警告標貼
11. 銘牌
12. 清潔壺
13. 中連桿
14. 高壓管
15. 蓮花噴頭
16. 槍柄
17. 槍桿

### 產品說明

#### 用途

- 高壓清潔機設計用於清潔私營部門的車輛、機器、建築及各種表面等。

### 應用範圍

- 在任何情況下均不得在可能發生爆炸的區域使用機器！
- 作業溫度必須介於0與+40°C之間。
- 機器由一個含幫浦的組件組成，裝在一個減震外殼中。為獲得最佳工作位置，機器配有一隻槍桿和一個防滑手柄，其形狀與配置符合適用法規。
- 請勿以任何方式覆蓋或改裝槍桿或噴嘴。
- 高壓清潔機設計在低溫或微溫（最高60°C）下使用；較高的溫度可能會損壞幫浦。
- 請勿使用髒水、或含沙粒或任何化學產品的水，因為此類水可能會影響作業，縮短機器的使用壽命。
- 可以將配件與泡沫清潔劑配合使用，進行噴沙。

### 裝配

- 將清洗機儘量靠近供水裝置。
- 清洗機必須位於一個安全、穩固的位置，如圖所示（圖2）。
- 將槍桿裝入噴槍，旋轉槍桿，直至兩個部件完全鎖定（圖3）
- 將噴槍連接至高壓軟管（圖4）
- 將高壓軟管連接至清洗機上的出水口（圖5）。
- 將供水軟管連接至母型聯結器（圖6），然後連接至清洗機的入水口。供水軟管的內徑必須至少為13mm（1/2英寸）且必須加固。供水量必須至少等於清洗機的輸送容量。

- **注：機器不適合連接至飲用水總管（圖13）。**

 **警告！** 進水溫度不得超過40°C。供水壓力不得超過0.7MPa。

 **小心！** 清洗機僅可使用乾淨的水；使用未過濾、含腐蝕性化學品的水將會損壞清洗機。

- 將電動機開關撥至「OFF」位置（圖8）。
- 檢查供電電壓與頻率(V/Hz)是否與清洗機銘牌上指定的數值一致。如果電源正確，則您即可插上清洗機的插頭。

## 操作

- 完全開啟供水裝置的水龍頭。
- 解除安全鎖（圖7），然後按下扳機幾秒鐘，讓空氣排出並排放軟管中的殘留壓力。
- 按住扳機，撥動開關以啟動電動機（圖8）。
- 重新啟動電動機時，務必按住扳機。

## 注：

電動機僅在扳機啟動的情況下運行。

## 正確使用標準配件

- 清洗機配有可調噴嘴。
- 從鉛筆噴嘴至渦扇噴嘴進行噴射調整（圖9）

**警告：**扣動扳機時請勿調整噴嘴。

## 建議的清潔程序

- 透過渦扇噴射機將洗滌劑噴塗至乾燥表面，溶解污垢。在垂直表面，從下至上操作。讓洗滌劑持續作用1至2分鐘，但不要讓其變乾。從表面的高處開始噴塗，從下至上操作。
- 避免沖洗用水流至不必要的表面。

## 儲存（圖10-圖12）

- 關閉清洗機。
- 關閉供水裝置的水龍頭。
- 使用之後，應從桶中清除洗滌劑殘留。
- 透過按住扳機來排放殘留壓力，直至槍桿噴嘴中不再流出水。
- 嚙合噴槍安全鎖。
- 從插座中拔出插頭。
- 冬季儲存之前，請使用非腐蝕性/無毒的防凍劑操作清洗機。

**警告：**重新使用之前，請使用普通的水徹底沖洗裝置。防凍劑可能會破壞塗料，因此重新使用之前，必須確保系統中未殘留任何防凍劑。

## 維護

**小心！**使用清洗機之前，請斷開接線片與電源插座的連接

- 為了確保獲得良好效能，每操作50小時之後即檢查並清潔一次吸入和洗滌劑過濾器（圖11）。
- 使用隨附的工具清潔噴嘴。從噴槍上取下槍桿；清除噴嘴孔中的污垢（圖12）並進行沖洗。

## 故障排除

進行使用者維護或檢查其是否正常運作之前，請斷開與電源的連接。

為避免陷於失望，聯絡維修機構之前，您應檢查以下各項：

症狀	原因	建議措施
機器拒絕啟動	機器的插頭未插入插座存在缺陷 熔斷器已熔斷 延長電線存在缺陷	插上機器的插頭 嘗試其他插座。 更換熔斷器。關閉其他機器。 嘗試不使用延長電線。
壓力波動	幫浦吸入空氣 閥門髒污、磨損或卡住 幫浦密封已磨損	檢查軟管與接頭是否密閉。 清潔並更換，或轉介至當地經銷商 清潔並更換，或轉介至當地經銷商
機器停止	熔斷器已熔斷 主電源電壓錯誤 熱感應器已啟動 噴嘴部分堵塞	更換熔斷器。關閉其他機器。 檢查主電源電壓是否與型號標籤上的規格一致。 讓清洗機冷卻5分鐘。清潔噴嘴
熔斷器熔斷	熔斷器過小	改用高於機器電流消耗量的裝置。您可嘗試不使用延長電線。
機器進行脈動	入口軟管中有空氣 總管供水不足 噴嘴部分堵塞 濾水器堵塞 軟管扭結	允許機器在扳機開啟的情況下運行，直至恢復正常工作壓力。 檢查供水是否與所需的規格一致 NB! 避免使用長且細的軟管（最小1/2"） 清潔噴嘴 清潔過濾器 理順軟管。
機器經常會自行啟動和停止	幫浦/噴槍是洩漏中心。	請與您最近的維修中心聯絡
機器已啟動，但沒有水流出	幫浦/軟管或配件已凍結 無供水 濾水器堵塞 噴嘴堵塞	等待幫浦/軟管或配件解凍。 連接入水口。 清潔過濾器 清潔噴嘴

如果出現以上問題之外的問題，請與您當地的經銷商聯絡。

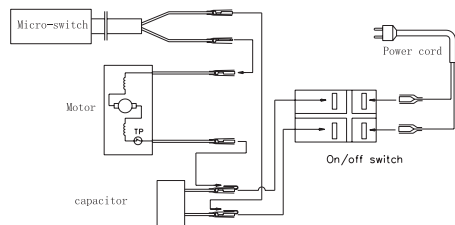

## 處置

### 回收清洗機

 請勿將電器作為未分類的城市廢物進行處置，使用分類收集設施。

請與您當地的政府聯絡以獲得有關可用收集系統的資訊。

如果在垃圾填埋場或堆填區處置電器，有害物質可能會洩漏到地下水，進入食物鏈，有損您的健康與福祉。

使用新器具更換舊器具時，經銷商在法律上有義務免費回收您的舊器具進行處置。

### 請保存這些安全指示

進口商: 永安實業股份有限公司

電話: 02-29994633

地址: 新北市三重區中山路286號1F