

# STANLEY

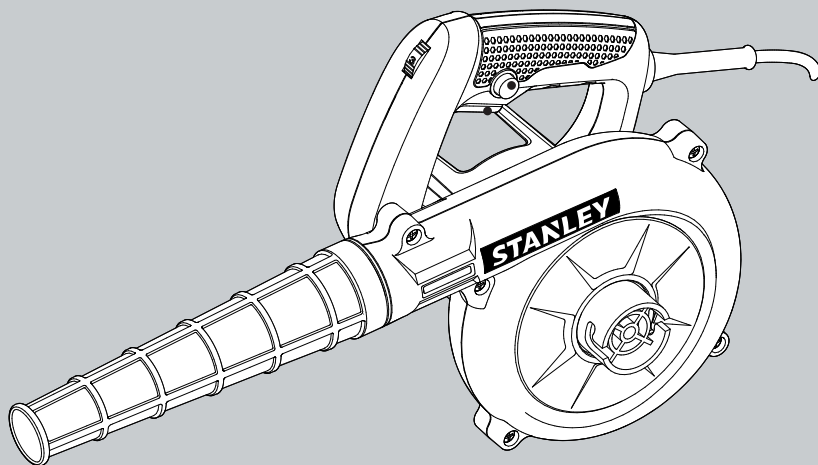

**STPT600**

**English**  
**繁體中文**

**3**  
**6**

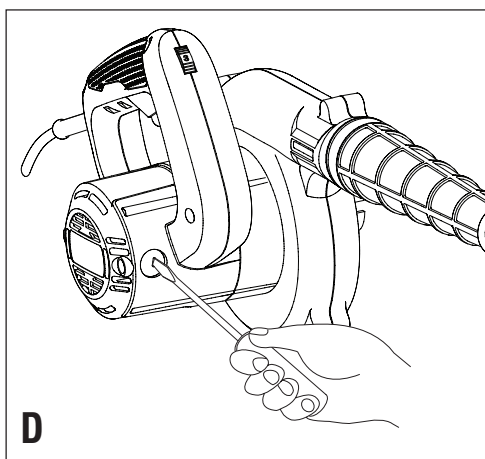
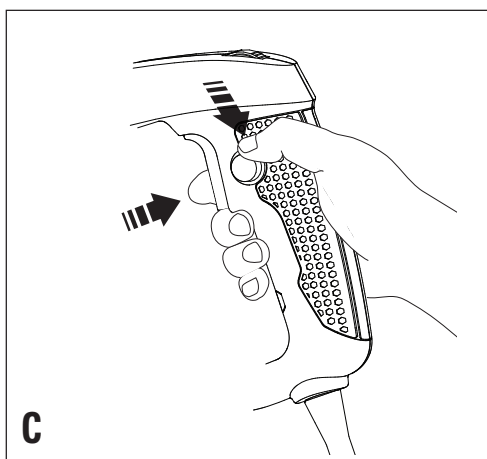
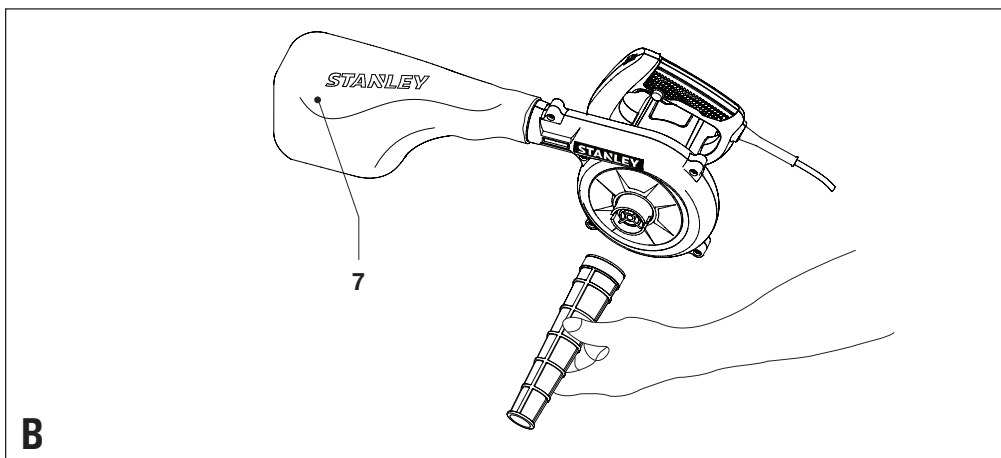
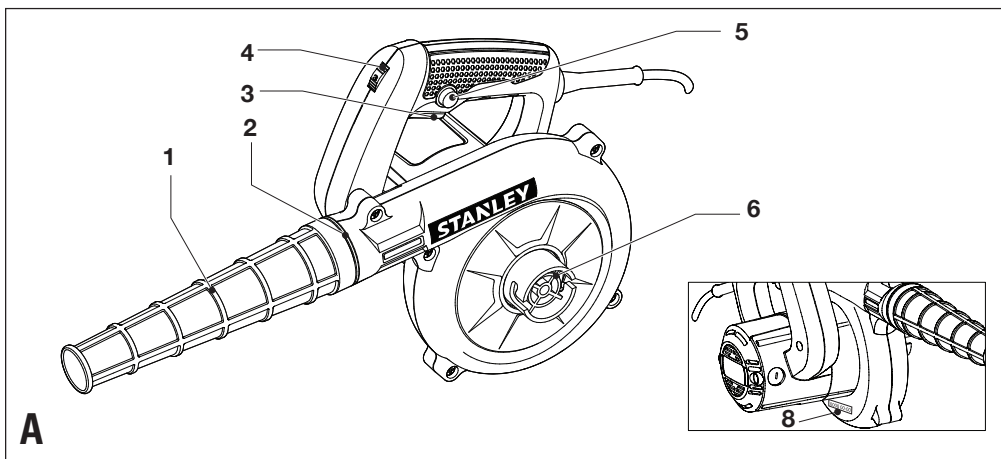

## STPT600 600W Variable Speed Blower

### Technical data

SPECIFICATION		STPT600
		TW
Voltage	V	110
Frequency	Hz	60
Power	W	600
No-Load Speed	/min	0-16,000
Air Volume	m <sup>3</sup> /min	3.5
Weight	Kg	1.6

### Intended use

Your Stanley Blower has been designed for blowing & cleaning applications, as well as light suction purpose.

### General Power tool Safety Warnings



**Warning! Read all safety warnings and all instructions.** Failure to follow the warnings and instructions may result in electric shock, fire and/or serious injury.

#### Save all warnings and instructions for future reference.

The term "power tool" in all of the warnings listed below refers to your mains operated (corded) power tool or battery operated (cordless) power tool.

#### 1. Work area safety

- Keep work area clean and well lit.** Cluttered or dark areas invite accidents.
- Do not operate power tools in explosive atmospheres, such as in the presence of flammable liquids, gases or dust.** Power tools create sparks which may ignite the dust or fumes.
- Keep children and bystanders away while operating a power tool.** Distractions can cause you to lose control.

#### 2. Electrical safety

- Power tool plugs must match the outlet. Never modify the plug in any way. Do not use any adapter plugs with earthed (grounded) power tools.**  
Unmodified plugs and matching outlets will reduce risk of electric shock.
- Avoid body contact with earthed or grounded surfaces such as pipes, radiators, ranges and refrigerators.** There is an increased risk of electric shock if your body is earthed or grounded.
- Do not expose power tools to rain or wet conditions.**  
Water entering a power tool will increase the risk of electric shock.
- Do not abuse the cord. Never use the cord for carrying, pulling or unplugging the power tool. Keep cord away from heat, oil, sharp edges or moving parts.** Damaged or entangled cords increase the risk of electric shock.

- When operating a power tool outdoors, use an extension cord suitable for outdoor use.** Use of a cord suitable for outdoor use reduces the risk of electric shock.
- If operating a power tool in a damp location is unavoidable, use a residual current device (RCD) protected supply.** Use of an RCD reduces the risk of electric shock.

#### 3. Personal safety

- Stay alert, watch what you are doing and use common sense when operating a power tool. Do not use a power tool while you are tired or under the influence of drugs, alcohol or medication.** A moment of inattention while operating power tools may result in serious personal injury.
  - Use personal protective equipment. Always wear eye protection.** Protective equipment such as dust mask, non-skid safety shoes, hard hat, or hearing protection used for appropriate conditions will reduce personal injuries.
  - Prevent unintentional starting. Ensure the switch is in the off-position before connecting to power source and/or battery pack, picking up or carrying the tool.** Carrying power tools with your finger on the switch or energising power tools that have the switch on invites accidents.
  - Remove any adjusting key or wrench before turning the power tool on.** A wrench or a key left attached to a rotating part of the power tool may result in personal injury.
  - Do not overreach. Keep proper footing and balance at all times.** This enables better control of the power tool in unexpected situations.
  - Dress properly. Do not wear loose clothing or jewellery. Keep your hair, clothing and gloves away from moving parts.** Loose clothes, jewellery or long hair can be caught in moving parts.
  - If devices are provided for the connection of dust extraction and collection facilities, ensure these are connected and properly used.** Use of dust collection can reduce dust-related hazards.
- #### 4. Power tool use and care
- Do not force the power tool. Use the correct power tool for your application.** The correct power tool will do the job better and safer at the rate for which it was designed.
  - Do not use the power tool if the switch does not turn it on and off.** Any power tool that cannot be controlled with the switch is dangerous and must be repaired.
  - Disconnect the plug from the power source and/or the battery pack from the power tool before making any adjustments, changing accessories, or storing power tools.** Such preventive safety measures reduce the risk of starting the power tool accidentally.

- d. **Store idle power tools out of the reach of children and do not allow persons unfamiliar with the power tool or these instructions to operate the power tool.** Power tools are dangerous in the hands of untrained users.
  - e. **Maintain power tools. Check for misalignment or binding of moving parts, breakage of parts and any other condition that may affect the power tool's operation. If damaged, have the power tool repaired before use.** Many accidents are caused by poorly maintained power tools.
  - f. **Keep cutting tools sharp and clean.** Properly maintained cutting tools with sharp cutting edges are less likely to bind and are easier to control.
  - g. **Use the power tool, accessories and tool bits etc., in accordance with these instructions, taking into account the working conditions and the work to be performed.** Use of the power tool for operations different from those intended could result in a hazardous situation.
- 5. Service**
- a. **Have your power tool serviced by a qualified repair person using only identical replacement parts.** This will ensure that the safety of the power tool is maintained.

## Additional Safety Instructions for Blowers

- Do not collect still smoldering cigarette ashes, freshly cut metals shaving, screws, nails and the like.
- Never block suction inlet and outlet.
- Do not cross gravel paths or roads whilst your product is switched on during blow/vac mode. Walk, never run.
- Always be sure of your footing, particularly on slopes.
- Do not overreach and keep your balance at all times.
- Do not place the inlet or outlet of the vacuum near eyes or ears when operating. Never blow debris in the direction of bystanders.
- Keep all cooling air inlets clear of debris.
- To protect your feet and legs while operating the appliance, always wear heavy duty footwear and long trousers.
- Never allow children to use the appliance.
- Wear protective goggles while operating.
- If operating an appliance in a damp location is unavoidable, use a Residual Current Device (RCD) with a tripping current of not more than 30mA protected supply. Use of an RCD reduces the risk of electric shock.

- To prevent dust irritation the wearing of a face mask is recommended.
- Disconnect the appliance from the mains supply
  - whenever you leave the machine;
  - before cleaning a blockage;
  - before checking, cleaning or working on the appliance;
  - if the appliance starts to vibrate abnormally.
- Store the appliance only in a dry place.

## Warning symbols



Do not use in the rain or leave outdoors while it is raining.



Always wear eye protection.



Always wear ear protection.



Keep bystanders away.



Do not touch the fan.



Switch off: remove plug from mains before cleaning or maintenance.

## Labels on tool

The following symbols are shown on the tool:



Warning! To reduce the risk of injury, the user must read the instruction manual.

## Position of Date Barcode

The Date Code (8), which also includes the year of manufacture, is printed into the housing.

Example:

2014 XX JN  
Year of manufacturing

## Electrical safety



This tool is double insulated; therefore no earth wire is required. Always check that the power supply corresponds to the voltage on the rating plate.

If the supply cord is damaged, it must be replaced by the manufacturer or an authorised Stanley Service centre in order to avoid a hazard.

The extension cable must be suitable for outdoor use and marked accordingly. Up to 0.75 mm<sup>2</sup> H05VV-F or H05RN-F extension cable can be used without loss of product performance.

## Features

This tool includes the following features:

1. Nozzle
2. Blast Port
3. Trigger Switch
4. Variable Speed Knob
5. Lock-On Button
6. Suction Port
7. Dust Bag

## Assembly

**Warning!** Before assembly, make sure that the tool is switched off and unplugged.

## Use

### Mounting The Nozzle For Blowing Operations (fig. A)

- Insert the pin located inside the Nozzle into the notch provided on the Blast Port (1)
- To lock Nozzle in place, turn the Nozzle in the direction indicated.
- To remove Nozzle, turn the Nozzle in the opposite direction.

### Mounting The Nozzle And Dust For Dust Collection (fig. B)

- For dust collection, mount the Dust Bag at the Blast Port (2) and Nozzle at the Suction Port (6)
- To remove Dust Bag and Nozzle, simply pull out by first turning in the opposite direction.
- Empty the Dust Bag frequently to ensure maximum dust collecting efficiency.

### Operating The Blower (fig. C)

- To switch your Blower on, depress the Switch (3). To stop your Blower, release Switch.
- Adjust Variable Speed Knob (4) for different speed requirement.
- When continuous operation is required, first depress the switch and then the lock-on button (5) and release to disengage lock, squeeze and release switch.

**Warning:** Continuous running of machine should not exceed 30 minutes.

### Replacing Carbon Brushes (fig. D)

- Use a screwdriver to remove the brush holder cap.
- Take out the worn carbon brush, insert the new one and secure the brush hold cap.

**Warning!** Remove and check the carbon brushes regularly. Replace when they wear down to the limit mark.

## Accessories

The performance of your tool depends on the accessory used. Stanley and Piranha accessories are engineered to high quality standards and designed to enhance the performance of your tool. By using these accessories you will get the very best from your tool.

## Maintenance

Your tool has been designed to operate over a long period of time with a minimum of maintenance. Continuous satisfactory operation depends upon proper tool care and regular cleaning.

**Warning!** Before performing any maintenance, switch off and unplug the tool.

- Regularly clean the ventilation slots in your tool using a soft brush or dry cloth.
- Regularly clean the motor housing using a damp cloth. Do not use any abrasive or solvent-based cleaner.

## Protecting the environment



Separate collection. This product must not be disposed of with normal household waste.

Should you find one day that your Stanley product needs replacement, or if it is of no further use to you, do not dispose of it with household waste. Make this product available for separate collection.



Separate collection of used products and packaging materials to be recycled and used again. Re-use of recycled materials helps prevent environmental pollution and reduces the demand for raw materials.

Local regulations may provide for separate collection of electrical products from the household, at municipal waste sites or by the retailer when you purchase a new product.

## STPT600 600W 吹吸風槍

### 技術資料

SPECIFICATION		STPT600
		TW
電壓	V	110
頻率	Hz	60
功率	W	600
空載轉速	/min	0-16,000
風量	m <sup>3</sup> /min	3.5
重量	Kg	1.6

### 設計用途

您的 Stanley 吹吸風槍適用於鼓風和清潔應用，以及所需吸力較小的用途。

### 電動工具一般安全警告



**警告！請閱讀所有安全警告及使用指示。**不遵循這些警告和指示可能會導致觸電、火災及/或嚴重傷害。

請妥善保存所有警告及說明以備將來查閱。

下列所有警告中的名詞「電動工具」是指電源驅動（插電）電動工具，或者電池驅動（充電）電動工具。

#### 1. 工作場地安全

- 保持工作場地清潔和明亮。混亂或黑暗的場地會引發事故。
- 請勿在易爆環境，如有易燃液體、氣體或粉塵的環境中操作電動工具。電動工具產生的火花會點燃粉塵或氣體。
- 請等待兒童和旁觀者離開之後才操縱電動工具。分心會導致您疏於控制。

#### 2. 電氣安全

- 電動工具插頭必須與插座相符。切勿以任何方式改裝插頭。需接地的電動工具不能使用任何配接器插頭。未經改裝的插頭和相符的插座可以減少觸電危險。
- 避免人體接觸接地表面，如管道、散熱片、爐灶和冰箱。若您的身體接地，可增加觸電危險。

- 請勿將電動工具暴露在雨中或潮濕環境中。水進入電動工具會增加觸電危險。
- 請勿濫用電線。請勿使用電線來搬運、拉動電動工具或拔出插頭。讓電線遠離熱、油、銳邊和活動部件。受損或纏繞的電線會增加觸電危險。
- 若要在戶外使用電動工具，請使用適合戶外使用的延長電纜。使用適合戶外使用的電線可減少觸電危險。
- 若必須在潮濕場合使用電動工具，請使用漏電保護器 (RCD)。使用 RCD 可降低觸電危險。

#### 3. 人身安全

- 保持警覺；在操作電動工具時，請留意所執行的操作並按照一般的程式執行。請勿在疲倦，或受到藥物、酒精或治療的影響下操作電動工具。操作電動工具期間注意力分散會導致嚴重人身傷害。
- 使用個人防護裝置。始終佩戴護目裝備。防護裝置，例如在適當條件下可使用的防塵面具、防滑安全鞋、安全帽或聽力保護等裝置可減少人身傷害。
- 避免意外啟動。連接電源及/或電池組、撿取或搬運電動工具之前，請確定開關處於關閉位置。搬運電動工具時若將手指放在開關上，或是在接通開關電源時插入插頭都會引發危險。
- 接通電動工具之前，請卸下所有的調整鑰匙或扳手。遺留在電動工具旋轉部件上的扳手或鑰匙會導致人身傷害。
- 請勿過度伸張雙手。時刻註意腳下與身體的平衡。如此即可在發生意外的情況下更好地控制電動工具。
- 適當穿著。請勿穿寬鬆衣服或佩戴飾品。讓您的頭髮、衣服和手套遠離活動部件。寬鬆衣服、佩飾和長髮可能會捲入活動部件。
- 若配備用於連接排屑裝置、集塵設備的裝置，請確定正確連接和使用這些裝置。使用集塵設備可減少與粉塵有關的危險。

#### 4. 電動工具的使用與注意事項

- 請勿超負荷使用電動工具。根據您的用途使用適當的電動工具。使用適當的電動工具、讓它在設計可負荷的應用內運轉，會讓您更有效、更安全

地執行工作。

- b. 若開關不能開啟或關閉電源，請勿使用該電動工具。不能用開關來控制的電動工具將存在危險，必須進行維修。
  - c. 在執行任何調整、更換配件或儲存工具之前，必須從電源上拔掉插頭及/或卸下電池組。這類防護性措施可降低電動工具意外啟動的風險。
  - d. 請將閒置的電動工具儲存在兒童無法接觸的地方，並且請勿讓不熟悉電動工具或對這些使用指示不瞭解的人員操作電動工具。電動工具在未經培訓的使用者手中會發生危險。
  - e. 維護電動工具。檢查活動部件是否對準或卡住、破損情況以及是否存在影響電動工具運行的其他情況。若有損毀，必須在使用之前修理電動工具。許多事故都是由於電動工具欠缺維護所導致。
  - f. 保持刀具鋒利和清潔。妥善維護、切削鋒利的切割工具不會輕易卡住並可更輕鬆控制。
  - g. 遵循使用指示以及工作條件和所要執行的工作使用電動工具、配件和工具刀頭等。不按照設計目的使用電動工具會導致危險。
5. 檢修
- a. 本電動工具必須由合格的維修人員並只採用相同的原廠部件來執行檢修。這將確保電動工具的安全性。

## 吹吸風槍之附加安全指示

- 請勿收集還在冒煙的煙灰、剛切削的金屬片、螺釘、釘子以及類似物體。
- 切勿堵塞吸風入口和出口。
- 當產品在鼓風/真空模式下開啟時，請勿跨過礫石路徑或道路。慢行，切勿跑動。
- 務必注意腳下，尤其是在斜坡上時。
- 請勿將手伸得過遠，並時刻注意身體的平衡。
- 操作時，請勿將真空入口和出口靠近眼睛或耳朵。切勿朝向旁觀者吹送碎片。
- 讓所有冷卻空氣入口無碎片。
- 為了在操作器具時保護您的腳和腿，務必穿著重型鞋類和長褲。
- 切勿讓兒童使用器具。
- 請在操作時戴上護目鏡。
- 若必須在潮濕場合使用此器具，請使用跳閘電流

不超過 30mA 的漏電保護器 (RCD)。使用 RCD 可降低觸電危險。

- 為了防止粉塵過敏，建議戴上面罩。
- 請在下列情況下將器具從電源斷開連接
  - 每當離開機器時；
  - 在清理堵塞前；
  - 在檢查、清潔或使用器具前；
  - 若器具開始異常震動。
- 應僅將器具儲存在乾燥的地方。

## 警告符號



請勿在雨中使用或在下雨時將其留在戶外。



始終佩戴護目裝備。



始終佩戴聽力保護器。



讓旁觀者離開。



請勿觸摸風扇。



關閉：在清潔或維護前，請從電源拔下插頭。



## 工具上的標籤

工具上可能會附帶下列符號：



**警告！**為了降低受傷的風險，使用者必須仔細閱讀使用手冊。

## 日期条形码 的位置

日期代碼 (8) 亦包括製造年份，已印刷在機殼內。

範例：2014 XX JN

製造年份

## 電氣安全



本工具採用雙重絕緣，因此無需接地線。請務必檢查電源電壓是否與銘牌一致。

若電源線損毀，必須送往製造廠商或授權的 STANLEY 服務中心更換以避免發生危險。

延長電纜必須適合戶外使用並清楚標示。最多可以使用 0.75 mm<sup>2</sup> H05VV-F 或 H05RN-F 延長電纜，而不會造成產品效能損失。

## 功能部件

本工具包括以下功能：

1. 噴嘴
2. 鼓風口
3. 觸發開關
4. 變速旋鈕
5. 鎖定按鈕
6. 吸風口
7. 集塵袋

## 裝配

**警告！** 裝配之前，請確定已關閉工具電源並拔出插頭。

## 使用

### 安裝用於鼓風操作的噴嘴（圖 A）

- 將噴嘴內的插銷插入鼓風口上的凹口 (1) 中。
- 要將噴嘴鎖定位，請沿指示方向旋轉噴嘴。
- 要拆下噴嘴，沿相反方向旋轉噴嘴。

### 安裝噴嘴和集塵袋（圖 B）

- 為了收集塵埃，請將集塵袋安裝在鼓風口 (2)，將噴嘴安裝在吸風口 (6)
- 要拆下集塵袋和噴嘴，只需先沿相反方向旋轉再拉出。
- 經常清空集塵袋，以確保最高的集塵效率。

### 操作吹吸風槍（圖 C）

- 要開啟吹吸風槍，按下開關 (3)。要停止吹吸風槍，鬆開開關。
- 調節變速旋鈕 (4) 以符合不同的速度要求。
- 當需要持續操作時，先按下開關，然後按下鎖定按鈕 (5) 並鬆開以解除鎖定，然後擠壓並鬆開開關。

**警告：** 持續運行機器不應超過 30 分鐘。

### 更換碳刷（圖 D）

- 使用螺絲起子以拆下刷架保護蓋。
- 取出磨損的碳刷，插入新碳刷並固定刷架保護蓋。

**警告！** 定期拆下並檢查碳刷，在磨損到限制標記時予以更換。

## 配件

電動工具的效能取決於所使用的配件。Stanley 和 Piranha 配件依據高品質標準進行規劃，並設計用於增強電動工具的效能。透過使用這些配件，工具將以最佳效能運作。

## 維護

您的工具採用卓越的設計，能夠長時間使用，並且只需最少的維護。若要持續獲得滿意的操作效果，需進行正確的工具維護和定期的清潔。

**警告！** 在執行任何維護工作前，請關閉電源並將工具插頭拔下。

- 定期使用軟刷或幹布清潔工具內的通風槽。
- 定期使用濕布清潔電動機外殼。請勿使用任何研磨性或基於溶劑的清潔劑。

## 保護環境



分類回收。本產品必須與一般家庭廢物分開處置。

若您發現您的 Stanley 產品需要進行更換，或您已經不再需要使用這些產品，請勿將其與家庭廢物一併處置。務必將本產品送往分類收集處。



分類收集用過的產品和包裝允許材料循環再生利用。重新使用回收的材料有助於防止環境污染，並降低對原材料的需求。

當地法規可能要求由市政廢物回收點，或由向您出售新產品的經銷商來提供將電子產品與家庭廢物分類收集的服務。

進口商：永安實業股份有限公司

地址：新北市三重區新北大道二段137號

電話：02-29994633