

STANLEY®

User's Manual and Operating Instructions

ST-11T-CPH-E



Compact Gas Heater

NEVER LEAVE HEATER UNATTENDED WHILE BURNING, CONNECTED TO A POWER SOURCE OR WHILE CONNECTED TO A FUEL SOURCE.

| Countries of Destination | Hose and Regulator Included | Hose and Regulator Not Included |
|--------------------------------|-----------------------------|---------------------------------|
| GB, IE, ES, PT, RO, PL, FR, DE | GB, IE | ES, PT, RO, PL, FR, DE |

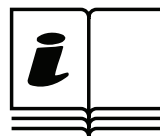

GB IR: 0657888160113

NEVER LEAVE HEATER UNATTENDED WHILE CONNECTED TO A POWER SOURCE

Read this User's Manual carefully and completely before attempting to operate or service this heater. If the information in this manual is not followed exactly, a fire or explosion may result causing property damage, personal injury or loss of life.

- Do not store or use gasoline or other flammable vapors and liquids in the vicinity of this or any other appliance.
- A fuel cylinder not connected for use shall not be stored in the vicinity of this or any other appliance.

WHAT TO DO IF THE SMELL OF GAS IS PRESENT:

- DO NOT attempt to light heater! Extinguish any open flame
- Shut off gas to heater.
- If odor continues, contact your local gas supplier or fire dept.
- Do not touch any electric switch, do not use any phone in your building
- Immediately call your gas supplier from a neighbor's phone. Follow the gas supplier instructions
- If you cannot reach your gas supplier, call the fire department
- Service must be done by a qualified service agency or the gas supplier

THIS HEATER MUST BE USED FOR SPACE HEATING. FOR OUT-DOOR USE ONLY, NOT FOR DOMESTIC USE.

1. Read and understand the instructions and safety warnings contained in the instruction manual before use. Failure to do so could result in personal injury or property damage. Failure to do so will also invalidate the warranty.
2. Only use the heater in well ventilated areas.
3. Ensure heater is correctly turned off after use and disconnect gas cylinder. Only fully qualified personnel should carry out maintenance and repair.
4. Ensure heater has cooled down before undertaking any maintenance.
5. DO NOT use heater in areas containing flammable or explosive material.
6. DO NOT point heater at the gas cylinder.
7. DO NOT operate the heater without the Safety Guard
8. DO NOT exceed the 100W / m³ limit considering the volume of the empty operating area.

▲ WARNING

This appliance requires a hose and regulator, which are defined in the instruction. Check with your gas supplier if not included.

▲ WARNING

General Safety Information
Fire, burn, inhalation, and explosion hazard. Keep solid combustibles such as building materials, paper, or cardboard, at a safe distance away from heater as recommended by the instructions. Never use the heater in spaces which do or may contain volatile or airborne combustibles or products such as gasoline, solvents, paint thinner, dust particles, or unknown chemicals.

▲ DANGER

Consumer: Retain these instructions for future reference.

IMPORTANT: Read this User's Manual carefully and completely before attempting to operate or service this heater.

Improper use of this heater can result in serious injury or death from burns, fire, explosion, electrical shock and /or carbon monoxide poisoning. DO NOT use this heater below ground level or in a basement.

Properly used, the heater provides safe economical heating. Products of combustion are vented into the area being heated.

▲ WARNING

Not for home or recreational vehicle use. This appliance does not contain an atmospheric sensing device. This appliance must only be used outdoors.

IMPORTANT SAFETY INFORMATION

- Children should be kept away.
- Always maintain proper clearance from combustible materials. Minimum clearance should be:
Sides -30.5 cm Top - 61 cm Front - 193 cm
- Do not modify heater, or operate a heater that has been modified.
- Adequate clearance for accessibility, combustion and ventilation (air supply) must be maintained at all times when heater is operating.
- Service and repair should be performed by a qualified service person. The heater should be inspected before each use, and at least annually by a qualified person. More frequent cleaning may be required as necessary. Do not service heater while hot or operating.
- Never connect heater to an unregulated gas supply.
- To prevent injury, always wear gloves when handling heater. Never handle an operating or hot heater, as severe burns may result.
- DO NOT operate a damaged heater. Check the heater thoroughly for damage before each use.
- Keep heater area free from combustible materials such as gasoline, paint thinners and other flammable vapors and liquids. Dust is combustible. Do not use heater in areas of high dust concentration.
- Always set heater on a stable, level surface.
- This heater is not for use on finished floors.
- Operate in a manner that heater will not be exposed directly to rain or dripping water.
- Keep curtains away from heater. Do not place clothing or any combustible items on heater.
- DO NOT attempt to convert to any other gas.
- Be sure that the fuel shut-off valve is closed tightly after each use.
- NEVER use heater in occupied dwellings, enclosed shelters, residential living areas, recreational vehicles, tents, or in non-adequately ventilated enclosed spaces.
- Never operate heater unless fuel cylinder is properly connected and installed.
- The guard on this appliance is to prevent risk of fire or injury from burns and no part of it should be permanently removed. IT DOES NOT GIVE FULL PROTECTION FOR YOUNG CHILDREN OR THE INFIRM.

Unpacking and Assembly

1. Remove heater from Carton (Save carton and packing materials for later storage).
2. Remove all protective packaging protecting heater during shipping.

WARNING. THIS HEATER MUST BE INSTALLED BY COMPETENT PERSONS IN ACCORDANCE WITH SUCH REGULATIONS AS ARE IN FORCE.

▲ CAUTION

This is an unvented portable heater. It uses air (oxygen) from the area which it is used. Ample combustion and ventilation air must be provided. This heater produces carbon monoxide, which has no odor. Burning the heater in an enclosed space can kill you.

NEVER LEAVE HEATER UNATTENDED WHILE CONNECTED TO A POWER SOURCE

Connecting to Gas Supply

IMPORTANT! This heater requires a hose & regulator which are defined in the instruction. Avoid twisting the hose.

1. To connect fuel cylinder, insert regulator end fitting into cylinder valve, rotate coupling nut clockwise and tighten.
2. Open valve on fuel cylinder slowly. If the valve is not opened slowly, the excess flow check valve in the regulator will stop the flow of gas. If this should happen, close the valve, wait one minute and re-open, slowly.

VENTILATION

Always provide a fresh air opening in the heated space a minimum of 25 cm² per kW of heat input (Hs), subject to a minimum of 50 cm², equally divided between high and low level. Provide a larger opening if more heaters are being used.

⚠ CAUTION

The fuel pressure regulator and hose assembly supplied with the heater must be used without alteration (when supplied).

Installation

1. Inspect fuel cylinder and hose connection to appliance to ensure it is in good condition.
2. Connect regulator to a gas supply cylinder.

NOTE: Optimum efficiency is achieved when the heater uses the appropriate full fuel cylinder

3. Slowly open the fuel cylinder. Leak test all gas connections with 50/50 soap and water solution prior to start-up. Soap bubbles indicate a gas leak. DO NOT use a match or flame to test for gas leaks.

Adjustment

Use only with the appropriate gases at the pressures listed on the gas chart (page 4). This appliance is operating correctly when the burners remain lit and glowing.

Lighting and Operating Instructions

1. Turn the knob on the fuel cylinder valve counterclockwise to open.
2. Turn control knob to "HI" position.
3. Press down the control knob and hold for 30 seconds. While holding down the control knob, press the igniter button several times until the burner ignites. Release the control knob about 1–20 seconds after the ignition.
4. When the central burner panel remains lit, turn the control knob to the desired position for heating.
5. Check to see the appliance operating pressure is correct according to gas chart (page 4).

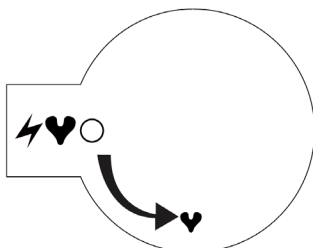

Figure 1

NOTE: If this is first time use for heater or fuel cylinder has been replaced, it may take a couple of seconds for the fuel to reach the heater. Continue to hold the flame until the ceramic plaques ignite. If they do not ignite after 15 seconds, remove the flame, close the fuel cylinder, wait 5 minutes for any fuel to dissipate and repeat steps 1-2.

Shutdown Instructions.

1. Turn the knob at the fuel cylinder clockwise to the OFF position
2. Turn the control knob to the OFF position.
3. After the plaques have stopped burning (no longer glowing), disconnect Regulator Hose assembly from the fuel cylinder.

NOTE: ALWAYS INSPECT HEATER BEFORE USE AND AT LEAST ANNUALLY BY A QUALIFIED SERVICE PERSON.

Maintenance / Storage

Always disconnect the fuel cylinder from the regulator assembly by means of the isolating valve, and remove the fuel cylinder from the appliance before putting appliance into storage. If for any reason the heater is to be stored indoors, the heater MUST be disconnected from the fuel cylinder, and the cylinder stored outdoors in a well-ventilated area, out of the reach of children. The plastic valve plug or valve cover supplied with the fuel cylinder must be reinstalled on the valve to protect the fitting from damage. Regularly check the hose and replace if necessary. This appliance must be left in a safe condition, must be moved from the danger situation such as high temperature, combustible and so on. If appliance is unable to be left in a safe condition, disconnect the fuel cylinder from appliance and store separately, and have appliance serviced by a qualified service person.

NOTE: There are no customer serviceable parts contained within this appliance. Repair of this heater should be done by a qualified service person.

Save all packaging materials that came with your heater, and re-package the heater for safe storage. Be sure to inspect the heater before each use to look for any such obstructions such as spiderwebs. Be sure to keep the air passage-ways, burner and combustion areas clean. This heater should receive a thorough cleaning with compressed air at least once every 30 days of operation. You may need to clean the heater more often if conditions are naturally dirty. Clean the Ceramic plaques using compressed air below 30 PSI to prevent damage.

HOW TO CHANGE A CYLINDER

1. Cylinders must be replaced in a non-flammable and non-smoking environment.
2. When you need to replace your empty cylinder, turn the gas off first.
3. Make sure that the heater is extinguished completely.
4. Remove the regulator from the empty cylinder and change a new full one.

NEVER LEAVE HEATER UNATTENDED WHILE CONNECTED TO A POWER SOURCE

Specifications

| | |
|---|---|
| THERMAL POWER (kW/BTU) | 3.4 / 11,687 |
| IGNITION | PIEZO |
| FUEL CONSUMPTION (g/h) | 246 |
| WEIGHT (kg) | 2.24 |
| MAX OPERATING HOURS | 129 |
| GAS CYLINDER SIZE | 5kg-15kg |
| HOSE TYPE (WHEN SUPPLIED) | Rubber or Plastic hoses complied with BS EN 16436-1:2014 |
| HOSE LENGTH (WHEN SUPPLIED) | 1.0m-1.5m |
| REGULATOR TYPE (WHEN SUPPLIED) | Pressure regulator complied with BS EN 16129:2013 |

| Gas Category | Gas Type and Supply Pressure | Country of Destination |
|---------------|--|------------------------|
| I3+(28-30/37) | G30 Butane at 28-30 mbar G31 Propane at 37 mbar | CZ, ES, FR, GB, IT, PT |
| I3B/P(30) | G30 Butane at 30 mbar G31 Propane at 30 mbar | DK, FI, IT, NL, RO, SE |
| I3B/P(50) | G30 Butane at 50 mbar G31 Propane at 50 mbar | DE |
| I3B/P(37) | G30 Butane at 37 mbar G31 Propane at 37 mbar | PL |
| I3P(30) | G31 Propane at 30 mbar | NL |
| I3P(37) | G31 Propane at 37 mbar | CZ, ES, FR, GB, IE, PT |
| I3P(50) | G31 Propane at 50 mbar | DE, ES, GB, NL |

Troubleshooting Guide

Specifications subject to change without notice

| Problem | Possible Cause | Solution |
|--|--|---|
| Burner does not light | <ol style="list-style-type: none"> 1. Air in gas line. 2. Gas pressure from cylinder too low 3. Fuel cylinder valve turned off 4. Obstruction in air passageway 5. Dirt in nozzle 6. Safety switch in cylinder valve engaged | <ol style="list-style-type: none"> 1. Depress the control knob for at least 30 seconds to remove any air in line. 2. Check fuel cylinder pressure. Tank may be empty. 3. Open fuel cylinder valve. 4. Inspect and clean heater housing 5. Blow out, or otherwise clean the nozzle 6. Close fuel cylinder valve. Wait one minute for switch to click off. Re-open fuel cylinder valve slowly |
| Heater stops running by itself | <ol style="list-style-type: none"> 1. Thermocouple damaged 2. Gas control valve damaged 3. Gas leak 4. Out of fuel 5. Thermocouple not in contact with pilot flame | <ol style="list-style-type: none"> 1. Have the thermocouple replaced by a qualified service person, 2. Have the gas control valve replaced by a qualified service person. 3. Check all connections for leaks. Any repairs must be made by a qualified service person. 4. Replace fuel cylinder. 5. Clean inside of burner housing |
| No spark is created when ignited | <ol style="list-style-type: none"> 1. Gas control valve damaged 2. Loose or disconnected igniter wire 3. Broken igniter wire | <ol style="list-style-type: none"> 1. Have the gas control valve replaced by a qualified service person. 2. Tighten or reconnect loose wire 3. Have the igniter wire replaced by a qualified service person. |
| The appliance does not stay lit smoothly or evently. | <ol style="list-style-type: none"> 1. The incorrect fuel is used or the incorrect pressure is used. | <ol style="list-style-type: none"> 1. Check fuel cylinder to assure the correct gas is being used at the correct pressure. |

Exploded View

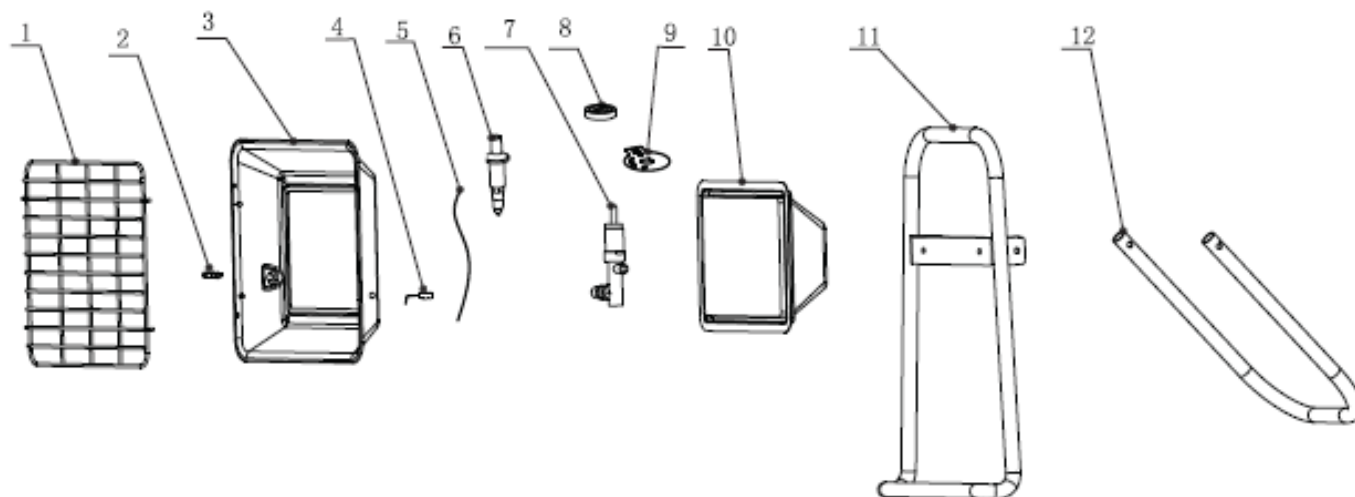

Figure 2 - Exploded View

Parts List

| ITEM # | DESCRIPTION |
|--------|---------------------|
| 1 | Safety Guard |
| 2 | Thermocouple |
| 3 | Reflector |
| 4 | Ignition Needle |
| 5 | Ignition Wire |
| 6 | Igniter |
| 7 | Valve Assembly |
| 8 | Control Knob |
| 9 | Indicator |
| 10 | Burner Frame |
| 11 | Handle / Front Leg |
| 12 | Rear Adjustable Leg |

STANLEY®

DO NOT RETURN THE UNIT TO THE STORE!

If you are having problems with your brand new Stanley product,
Please call our Technical Support at:

0845 076 6158

**Technicians are standing by to help you
Monday – Friday from 8am –5:30pm.**

To expedite your call, please have your Model Number and Serial Number Available.

STANLEY®

Manufactured by:
Pinnacle Climate Technologies, Inc.
Sauk Rapids, MN 56379 USA

EC REP

© 2017 Obelis S.A
Registered Address:
Bd. Général Wahis, 53, 1030 Brussels, Belgium